

6

5

4

3

2

1

## NOTES:

## ELECTRICAL PROPERTIES:

1. THERE SHOULD BE NO OPEN/SHORT, MISWIRING AND INTERMITTENT FAILURES.
2. THE CABLE SHALL BE 100% ELECTRICAL TEST.
3. VOLTAGE TEST: DC 300V 10MS;  
INSULATION RESISTANCE: 5.0M OHM/MIN  
CONDUCTANCE RESISTANCE: 5.0 OHM/MAX.

## MACHINERY CHARACTER:

1. ALL DIMENSIONS ARE REFERENCE ONLY
2. THE CABLE SHOULD BE CLEAN, FREE OF OILED/FLASH/BURRED.
3. PACKAGE: INDIVIDUALLY PACKAGED IN A CLEAR POLYBAG.
4. CABLE ASSY SHALL BE RoHS COMPLIANT.

REVISION					
ZONE	REV	DESCRIPTION	DATE	CHANGED BY	APPROVED
	C	ECO-13789	11/14/2024	KGLEBOVA	DGUST

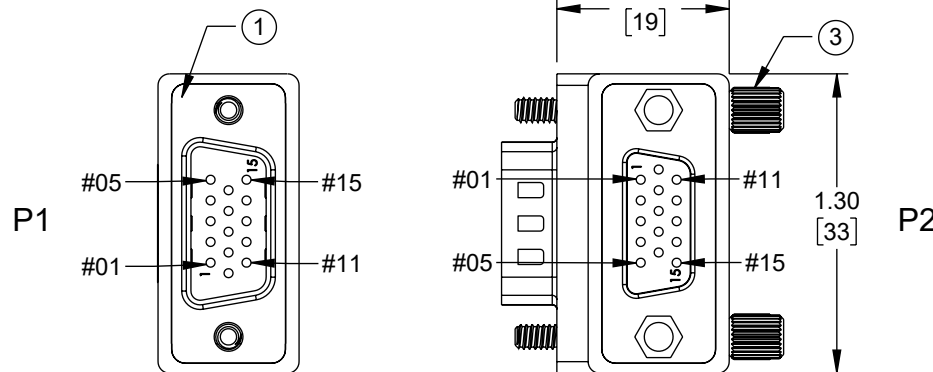
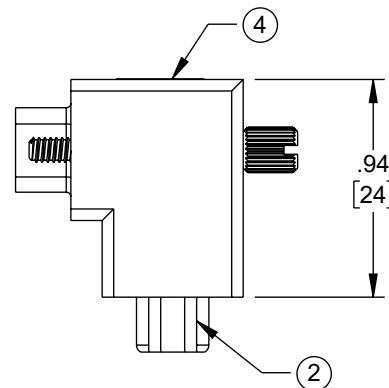

## PIN OUT

P1	P2
1	1
2	2
3	3
4	4
5	5
6	6
7	7
8	8
9	9
10	10
11	11
12	12
13	13
14	14
15	15
S	S

4	OUTER MOLDED: 45P PVC, COLOR: BLACK.	G	10
3	SCREW: 3.0*28.0MM(#4-40UNC), NICKEL PLATED.	PCS	2
2	P2 CONN: HDB15P, FEMALE, WITH FRONT SCREW, INSULATION BLUE, SHELL & PIN GOLD FLASH.	PCS	1
1	P1 CONN: HDB15P, MALE, INSULATION BLUE, SHELL & PIN GOLD FLASH.	PCS	1
ITEM	DESCRIPTION	UNIT	QTY

UNLESS OTHERWISE SPECIFIED  
LEADING DIMENSIONS ARE INCHES  
DIMENSIONS IN [ ] ARE MILLIMETERS

TOLERANCES:  
 X = ±.2 [5]      FRACTIONS  
 .XX = ±.02 [0.5]      ± 1/32  
 .XXX = ±.005 [0.13]      ANGLES ± 1°

CABLE LENGTH TOLERANCES:  
 ≤12 [305] = +1 [25] / -0  
 >12 [305] ≤ 60 [1524] = +2 [51] / -0  
 >60 [1524] ≤ 120 [3048] = +4 [102] / -0  
 >120 [3048] ≤ 300 [7620] = +6 [152] / -0  
 >300 [7620] = +5% / -0

ALL DIMENSIONS ARE FOR REFERENCE ONLY  
AND SUBJECT TO CHANGE WITHOUT NOTICE.  
UN-DIMENSIONED/NON-CRITICAL FEATURES  
MAY VARY IN SIZE AND LOCATION  
COLORS MAY VARY

**L-com**  
an INFINIT® brand

Website: www.L-com.com  
Phone: 1.800.341.5266 | 1.978.682.6936

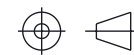

INTERPRET ALL DIMENSIONS AND  
TOLERANCES PER ASME Y14.5

SCALE: NONE      SHEET: 1 OF 1

DESCRIPTION

HDB15-F-M R/A ADP

THE INFORMATION CONTAINED IN THIS DRAWING IS THE SOLE PROPERTY OF INFINITE ELECTRONICS, INC. ANY REPRODUCTION IN PART OR WHOLE WITHOUT THE WRITTEN PERMISSION OF INFINITE ELECTRONICS, INC. IS PROHIBITED. THESE COMMODITIES, TECHNOLOGY OR SOFTWARE WERE EXPORTED FROM THE UNITED STATES IN ACCORDANCE WITH THE EXPORT ADMINISTRATION REGULATIONS. DIVERSION CONTRARY TO U.S. LAW PROHIBITED.

SIZE	CAGE CODE	DRAWN BY	ITEM NO.	REV
A	43321	JYOU	VGC00001	C

6

5

4

3

2

1