

THE INFORMATION CONTAINED IN THIS DRAWING IS THE SOLE PROPERTY OF L-COM, INC. ANY REPRODUCTION IN PART OR WHOLE WITHOUT THE WRITTEN PERMISSION OF L-COM, INC. IS PROHIBITED.

REVISIONS			
REV	DESCRIPTION	DATE	APPROVED
A	INITIAL RELEASE	8/11/11	D.GRIFFIN

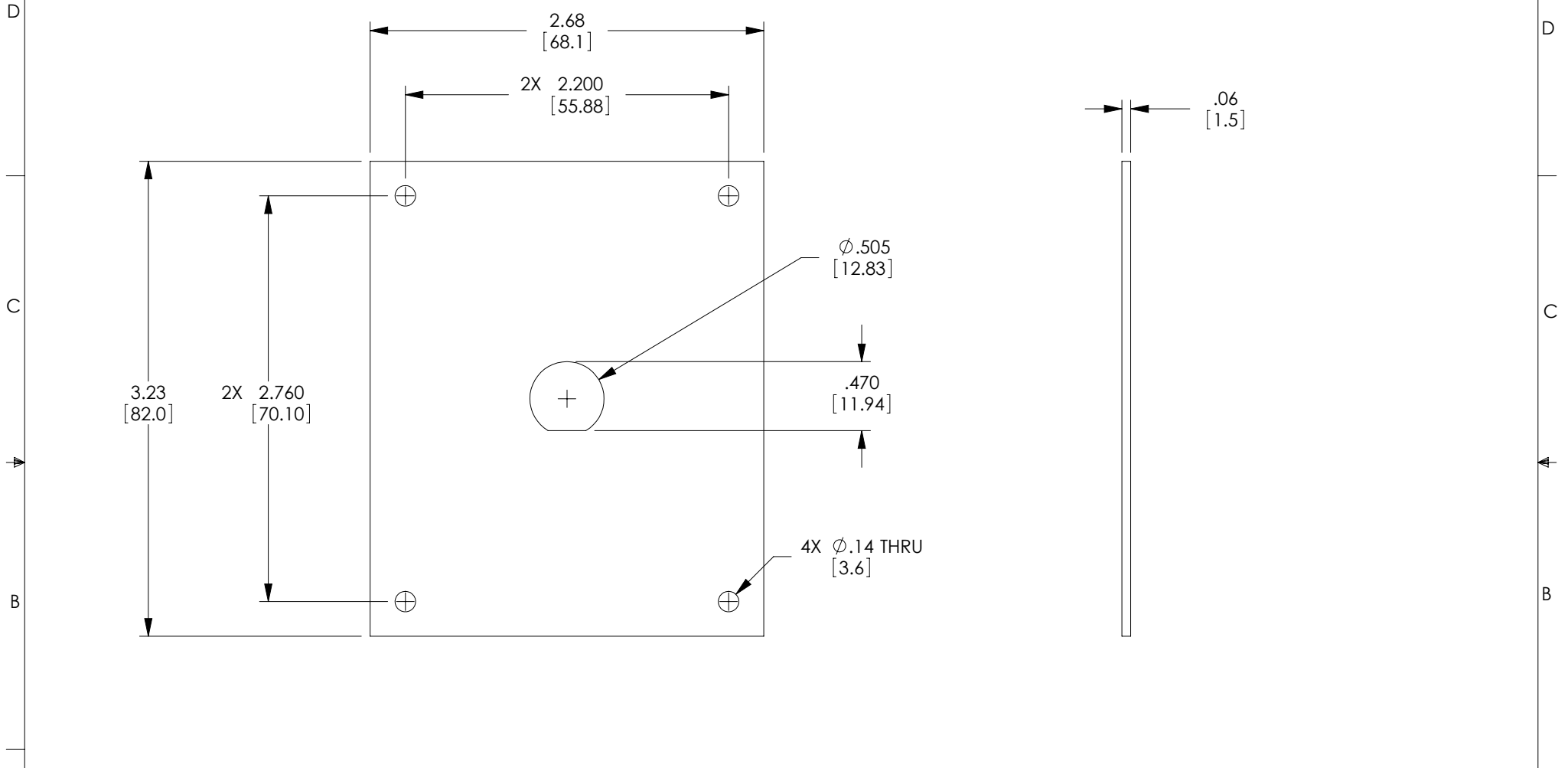

NOTES:

1. MATERIAL: .06 THICK ALUMINUM.
2. PANEL FINISH: FLAT BLACK ANODIZED.
3. PANEL SHALL BE PACKAGED IN ACCORDANCE WITH L-COM SPECIFICATION PS-0031.
4. KIT CONTAINS 4X, #6-32 UNC-2A X 5/16 LG PAN HEAD SCREWS, AND 4X, #6-32 UNC-2B EXTERNAL STAR LOCK NUTS IN A SMALL POLY BAG.

RoHS Compliant ✓

UNLESS OTHERWISE SPECIFIED, DIMENSIONS ARE IN INCHES [mm] OVERALL CABLE LENGTH TOLERANCE: ≤12 [305] = +1 [25] / -0 >12 [305] ≤60 [1524] = +2 [51] / -0 >60 [1524] ≤120 [3048] = +4 [102] / -0 >120 [3048] ≤300 [7620] = +6 [152] / -0 >300 [7620] = +3% / -0% ALL OTHER DIMENSIONAL TOLERANCES: .X = ±.2 .XX = ±.02 .XXX = ±.005	APPROVALS DRAWN BY D.FRISIELLO	DATE 8/11/11		45 BEECHWOOD DRIVE NORTH ANDOVER, MA 01845		
	CHECKED BY M.SEDLESKI APPROVED BY M.MARTINEZ	8/11/11 8/11/11		CATEGORY SUB PANELS		
PROJECTION 	CONFIGURATION DETAILS OF UNDIMENSIONED FEATURES MAY VARY	PRODUCT DESCRIPTION 1 D-HOLE SUB PANEL	SIZE A	FSCM NO. 43321	DWG. NO. USP-A1	REV. A
COLOR VARIATIONS MAY OCCUR			SCALE: NONE	CAD FILE: USP-A1.SLDDRW	SHEET 1 OF 1	