

THE INFORMATION CONTAINED IN THIS DRAWING IS THE SOLE PROPERTY OF L-COM, INC. ANY REPRODUCTION IN PART OR WHOLE WITHOUT THE WRITTEN PERMISSION OF L-COM, INC. IS PROHIBITED.

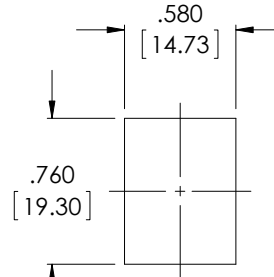

REVISIONS			
REV	DESCRIPTION	DATE	APPROVED
F	ECN 6881: UPDATED FORMAT, PKG, NOTES, REVISED PANEL OPENING	6/17/13	D. DESJARDIN

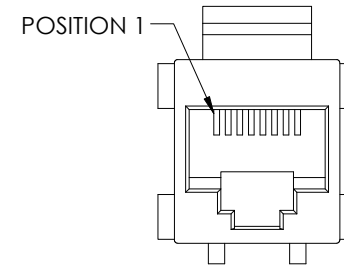
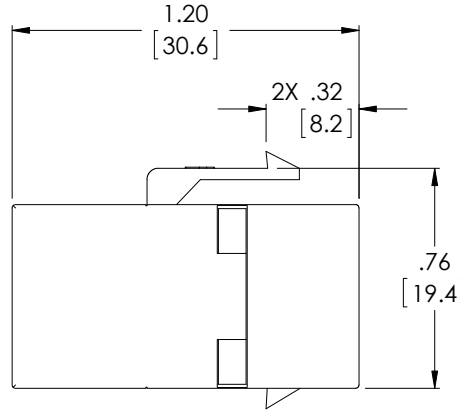
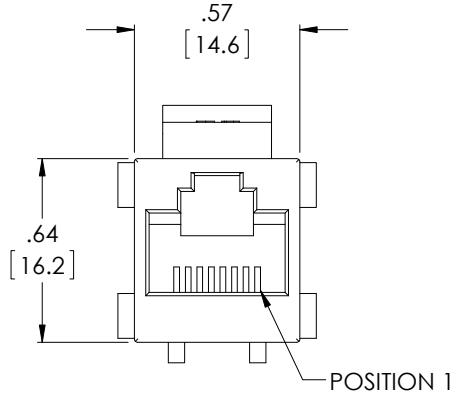

RECOMMENDED
PANEL OPENING



NOTES:

MATERIALS:
HOUSING: ABS, UL94V-0, COLOR: IVORY
CONTACTS: PHOSPHOR BRONZE
CONTACT PLATING: 50μINCHES GOLD OVER NICKEL PLATING
SHIELD: STEEL

ELECTRICAL:
RATING: CATGORY 3
CURRENT RATING: 1.5 AMPS MAX.
VOLTAGE RATING: 1000 V

ENVIRONMENTAL:
OPERATING TEMPERATURE RANGE: -0°C TO 60°C

MISCELLANEOUS:
WIRING: STRAIGHT THROUGH
COMPONENT SHALL BE INDIVIDUALLY PACKAGED IN ACCORDANCE WITH L-COM SPECIFICATION PS-0031.
MAXIMUM PANEL THICKNESS: .06"

ALL DIMENSIONS ARE FOR REFERENCE ONLY.

REGULATORY COMPLIANCE:
ROHS, CE

UNLESS OTHERWISE SPECIFIED, DIMENSIONS ARE IN INCHES [mm] OVERALL CABLE LENGTH TOLERANCE: ≤12 [305] = +1 [25] / -0 >12 [305] ≤60 [1524] = +2 [51] / -0 >60 [1524] ≤120 [3048] = +4 [102] / -0 >120 [3048] ≤300 [7620] = +6 [152] / -0 >300 [7620] = +5% / -0% ALL OTHER DIMENSIONAL TOLERANCES: .X = ±.2 [5.08] .XX = ±.02 [1.51] .XXX = ±.005 [1.27]	APPROVALS	DATE		45 BEECHWOOD DRIVE NORTH ANDOVER, MA 01845	
	DRAWN BY TJC	12/17/01			
	CHECKED BY DFP	12/18/01	CATEGORY	TELECOM/MODULAR	
	APPROVED BY CM	12/18/01	PRODUCT DESCRIPTION		
PROJECTION 	COLOR VARIATIONS MAY OCCUR	SIZE A	FSCM NO. 43321	DWG. NO. TDG1026KS-8P	REV. F
		SCALE: NONE	CAD FILE: TDG1026KS-8P.SLDDRW		SHEET 1 OF 1