

MATERIALS	
BODY	NICKEL PLATED BRASS
CONTACT	GOLD PLATED BRASS
INSULATOR	TEFLON

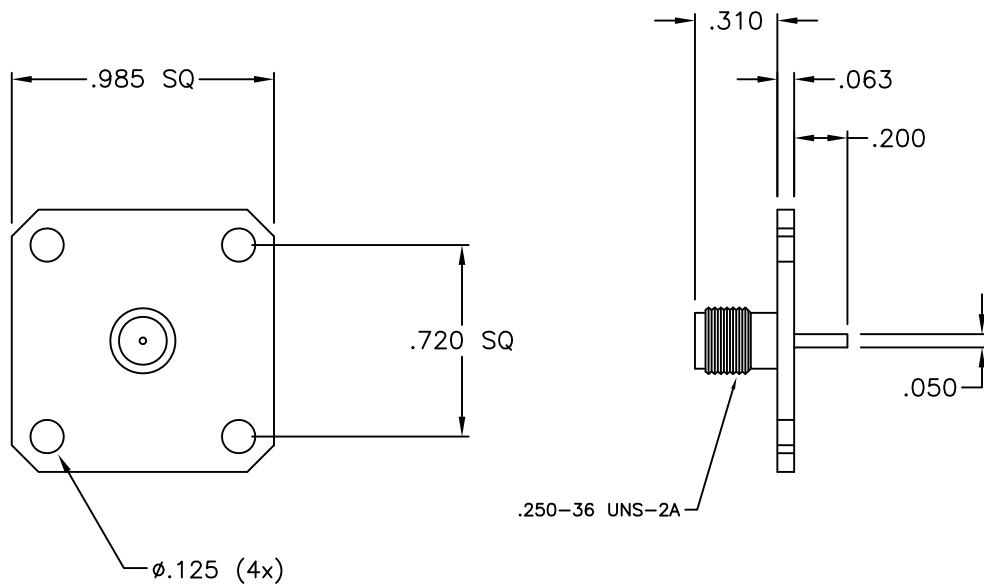

NOTES:  
 1. UNLESS OTHERWISE SPECIFIED ALL DIMENSIONS ARE NOMINAL.  
 2. ALL SPECIFICATIONS ARE SUBJECT TO CHANGE WITHOUT NOTICE AT ANY TIME.

				SIZE	TITLE:			
				A	Panel Mount - RP-SMA-Jack for PCB			
C	HL_4136	7/20/2009	Hole Size .250 to .125					
B	-	1/18/2007	Changed Scaling Factor					
REV	ECN No.	DATE	DESCRIPTION	DRAWN BY	B.Puchaski	07/20/09	DRAWING No.	ARSJ-4000
				ORIGINATOR	P. Pesa	04/17/03		C
				APPROVAL	M. Audas	07/20/09	PART No.	ARSJ-4000
				SCALE	2:1	SHEET 1/1	MATERIAL	Noted
							FILE No.	ARSJ-4000